

B143 Metal fitting to fix corner legs

- Gap used to happen between table top and legs while using table in case of using the former plate when you install legs on the corners of the table. However, using table hook can avoid having gap and can joint table top and legs more tightly at the same time.
- Recommended leg size/60mm square ~ 75mm square
- Material/Plate • Steel/Table hook • Steel
- Finishing/Table hook • Zink plating
Table hook • Zink
- Recommended installation screw/ Table top side • Truss head Diameter 8mm
Leg side • Countersunk head Diameter 5mm
Table hook • Countersunk head Diameter 5mm
- Quantity/200 pcs.

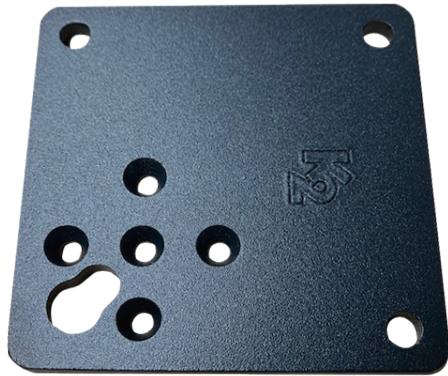

Table hook



Plate

Feature

Table hook can prevent the plate to float

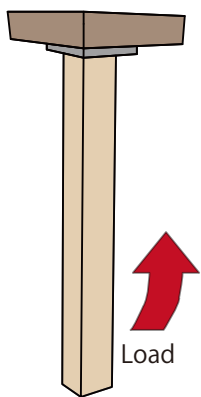

B143

* Fix the corners tightly

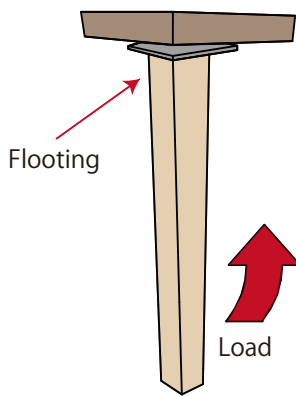

Usual plate

* Can't fix the corner with screw

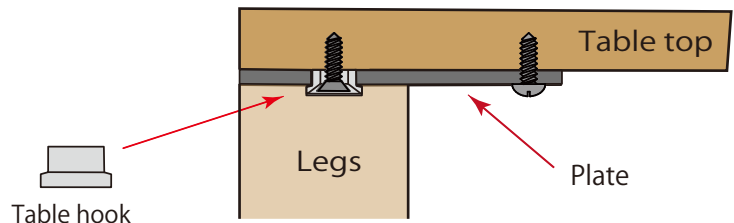

Strong product against weighting diagonally

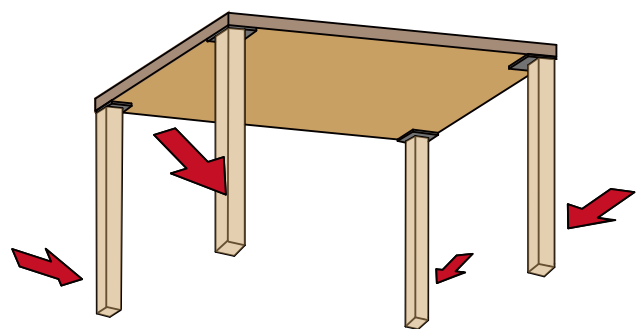

Metal fitting dimension

Plate

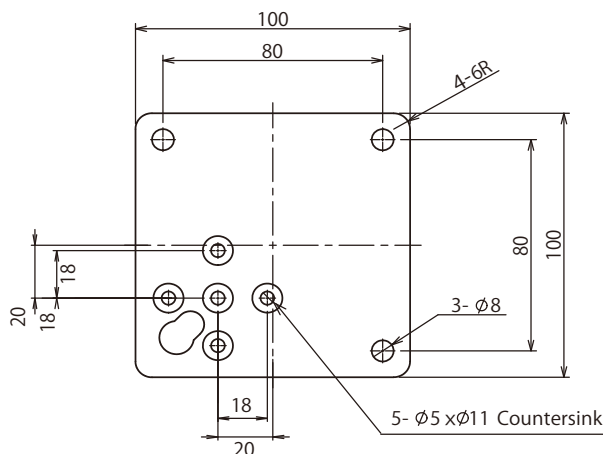
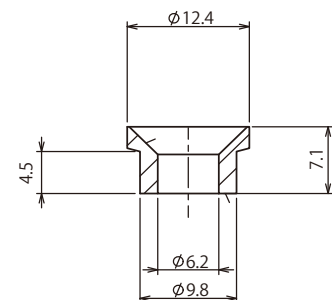
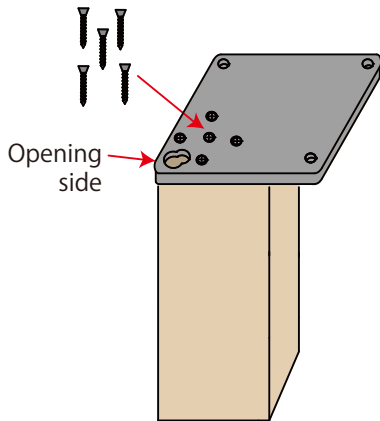

Table hook



How to install

① Table leg



② Table top

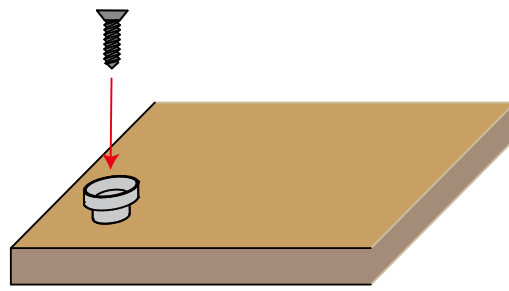

* Please refer to wooden part processing dimension drawing

① Install a plate to leg side

② Install a table hook to table top side

* In case that table hook sinks into wooden part because material of table top is soft, usage E204 insert nut D type or E210 insert nut S type is recommended

Installation process

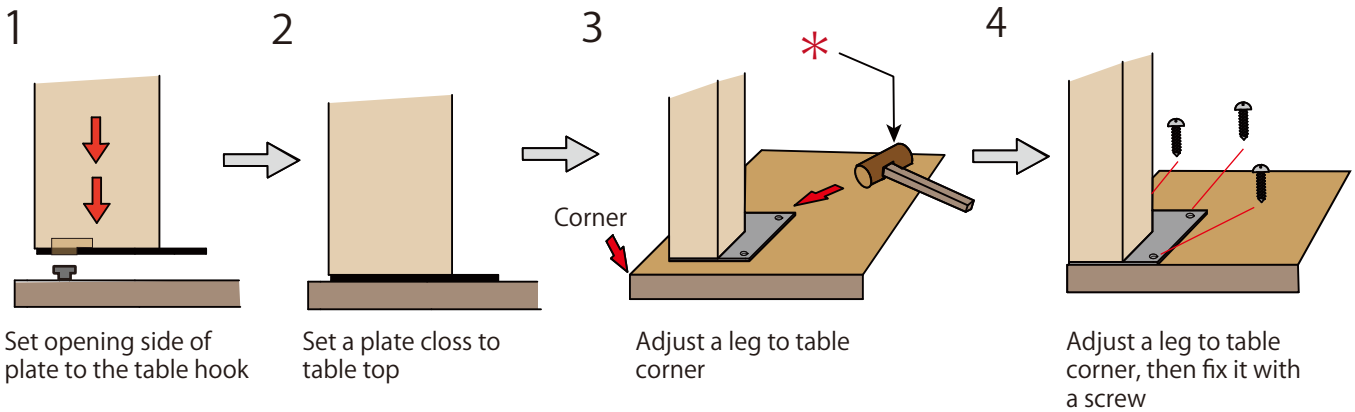

* It's designed not to make a gap to prevent rattalling. Push in squeezing into left and right following process 3 when it's hard to adjust to the corner or hit with a wooden hammer not to hurt furniture.

Wooden part processing dimension

Table top

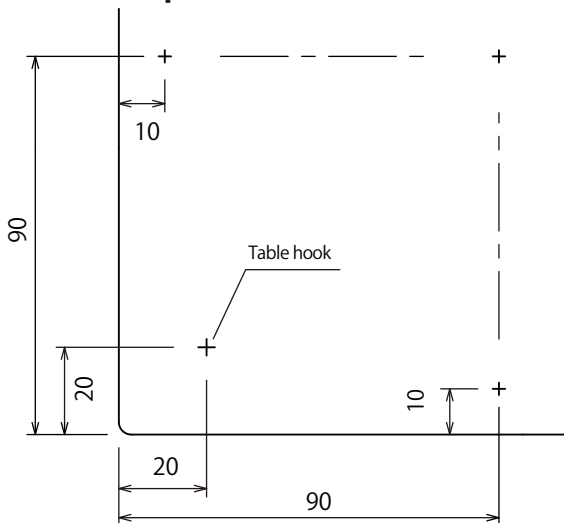

Leg part

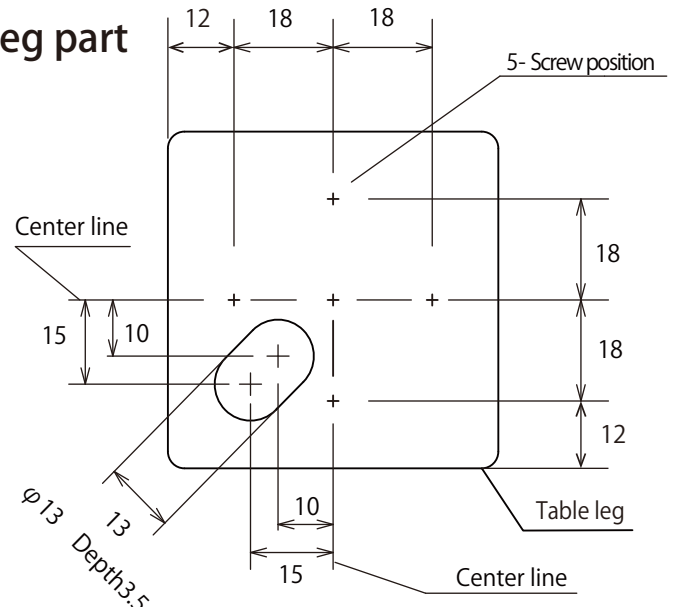

KOJIMA METAL FITTING CORPORATION

Head office 3-4-1 Motoasakusa, Taito-ku, Tokyo 111-0041, Japan
TEL +81-3-3843-3141 FAX +81-3-3843-3144

Kasukabe branch 1-26-20 Kasukabehigashi, Kasukabe-shi, Saitama 344-0062, Japan
TEL +81-48-760-3881 FAX +81-48-760-3883

✉ kanamono@kojima-mf.co.jp

